

# Soils Map

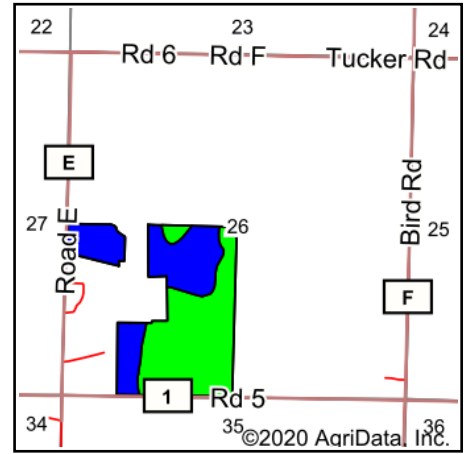

State: **Kansas**  
 County: **Seward**  
 Location: **26-34S-34W**  
 Township: **Liberal**  
 Acres: **98.05**  
 Date: **11/18/2020**

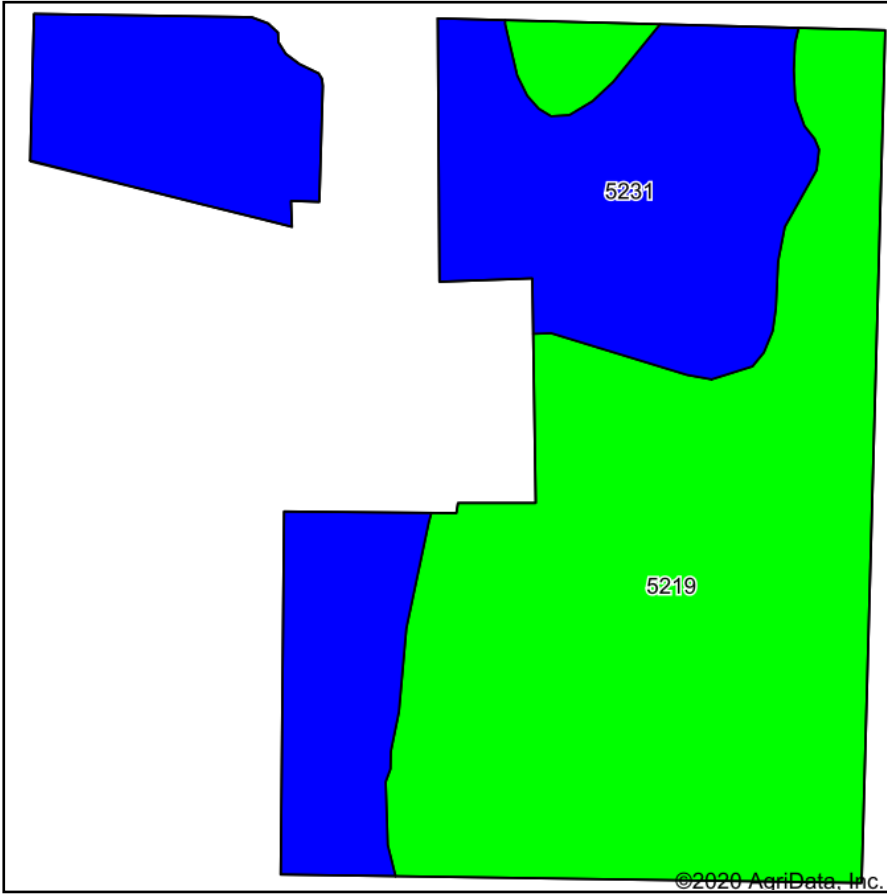

Soils data provided by USDA and NRCS.

Area Symbol: KS175. Soil Area Version: 17									
Code	Soil Description	Acres	Percent of field	Non-Irr Class Legend	Non-Irr Class	Irr Class	Range Production (lbs/acre/yr)	Corn Irrigated	*n NCCPI Overall
5219	Dalhart loamy fine sand, 0 to 3 percent slopes	56.34	57.5%		IIIe	IIIe	1600	144	43
5231	Eva-Optima-Dalhart complex, 0 to 5 percent slopes	41.71	42.5%		IVe	IIIe	1430	115	33
<b>Weighted Average</b>							<b>1527.7</b>	<b>131.7</b>	<b>*n 38.7</b>

\*n: The aggregation method is "Weighted Average using all components"  
 Soils data provided by USDA and NRCS.