

# Soils Map

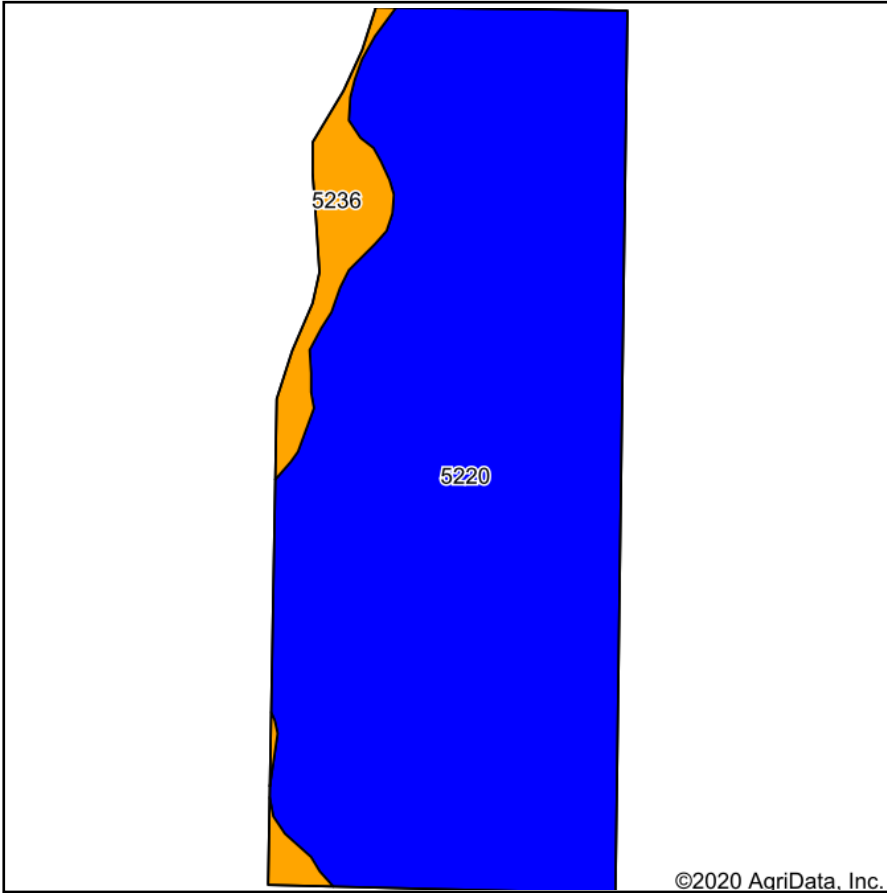

Soils data provided by USDA and NRCS.

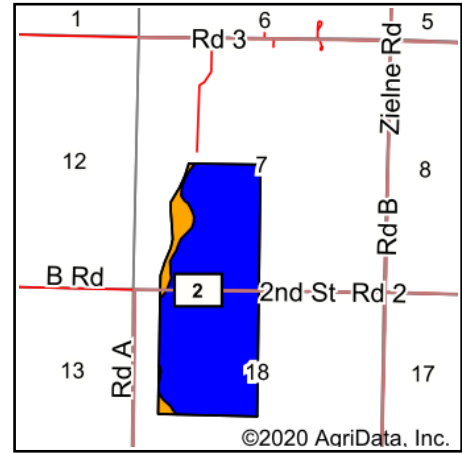

State: **Kansas**  
 County: **Seward**  
 Location: **18-35S-34W**  
 Township: **Liberal**  
 Acres: **236.33**  
 Date: **11/18/2020**



Area Symbol: KS175. Soil Area Version: 17										
Code	Soil Description	Acres	Percent of field	Non-Irr Class Legend	Non-Irr Class	Irr Class	Range Production (lbs/acre/yr)	Corn Irrigated	*n NCCPI Overall	
5220	Dalhart loamy fine sand, 3 to 5 percent slopes	221.55	93.7%		Ive	IIle	1700	153	45	
5236	Eva-Optima complex, 5 to 15 percent slopes	14.78	6.3%		Vle	Vle	1333	32	23	
<b>Weighted Average</b>							<b>1677</b>	<b>145.4</b>	<b>*n 43.6</b>	

\*n: The aggregation method is "Weighted Average using all components"  
 Soils data provided by USDA and NRCS.