

Soils Map

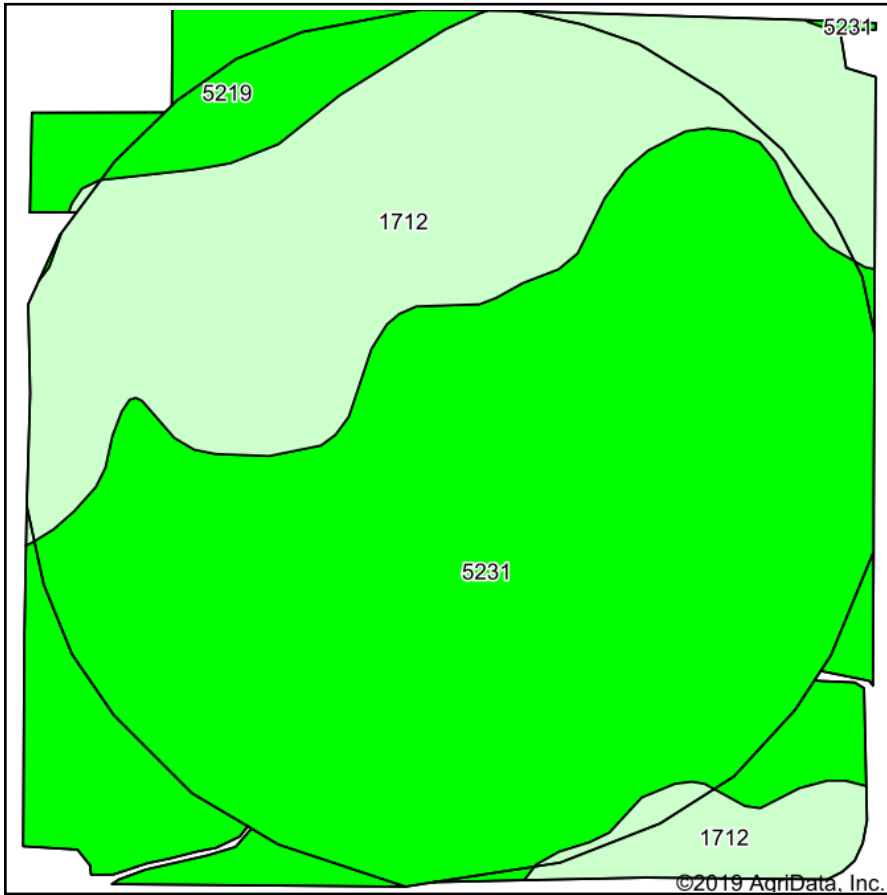

Soils data provided by USDA and NRCS.

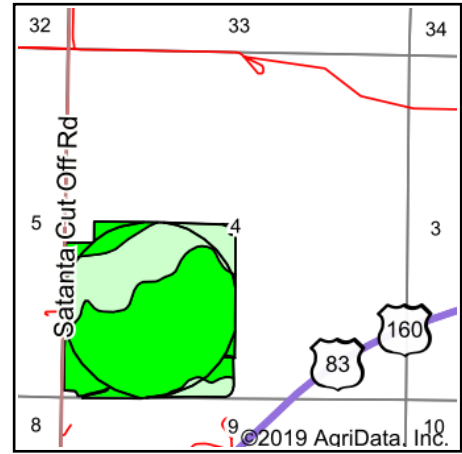

State: **Kansas**
 County: **Seward**
 Location: **4-33S-33W**
 Township: **Liberal**
 Acres: **156.47**
 Date: **6/17/2020**



Area Symbol: KS175. Soil Area Version: 16									
Code	Soil Description	Acres	Percent of field	Irr class Legend	Non-Irr Class	Irr Class	Range Production (lbs/acre/yr)	Corn Irrigated	*n NCCPI Overall
5231	Eva-Optima-Dalhart complex, 0 to 5 percent slopes	98.25	62.8%		IVe	IIIe	1430	115	32
1712	Otero-Schamber complex, warm, 5 to 20 percent slopes	49.41	31.6%		Vle		1613		29
5219	Dalhart loamy fine sand, 0 to 3 percent slopes	8.81	5.6%		IIle	IIIe	1600	144	43
Weighted Average							1497.4	80.3	*n 31.7

*n: The aggregation method is "Weighted Average using major components"
 Soils data provided by USDA and NRCS.